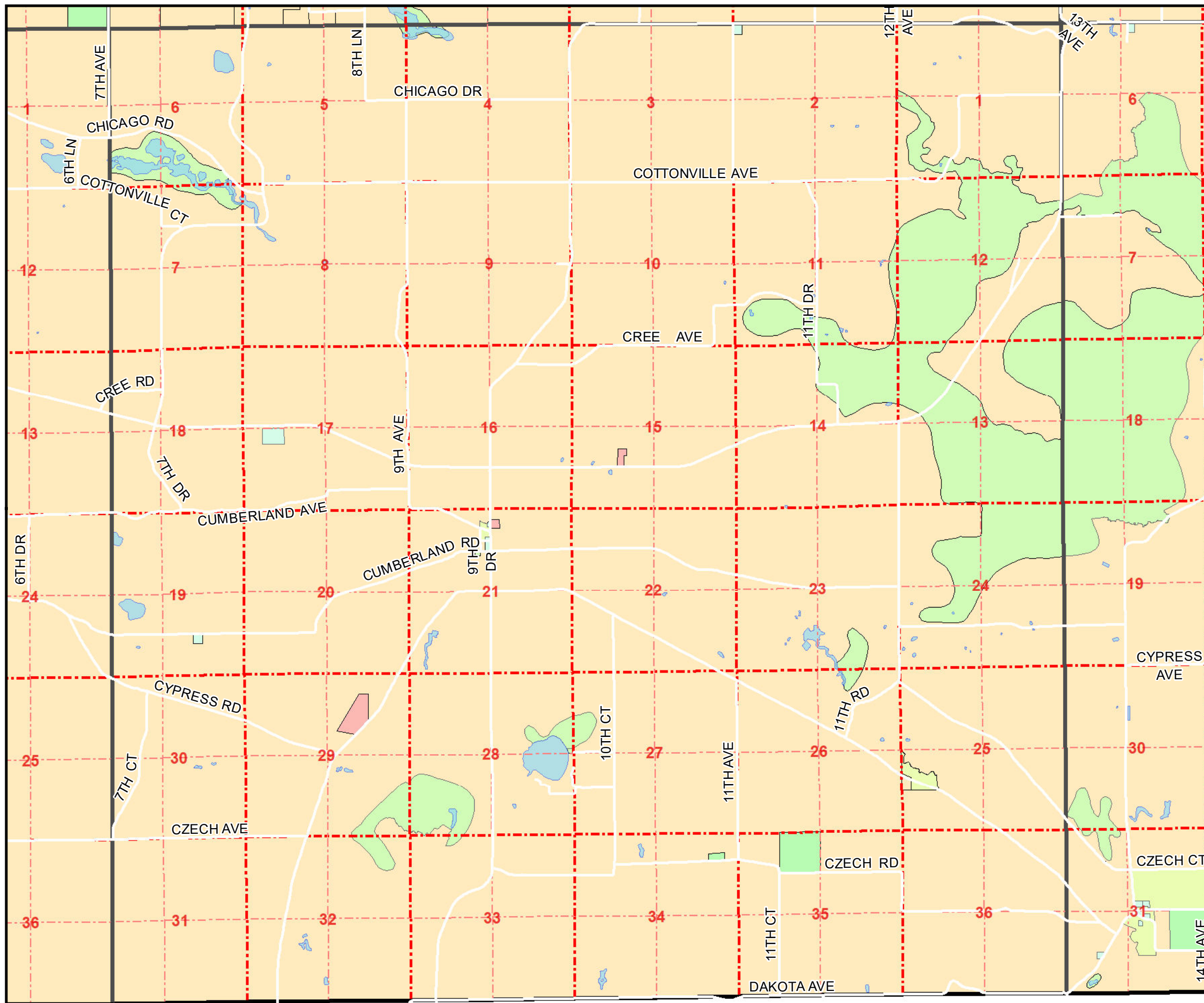
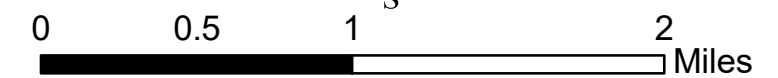
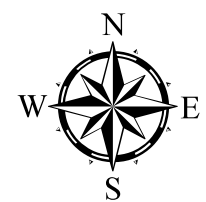

EXHIBIT 8-2 TOWN OF RICHFORD EXISTING ZONING



- (A-G) General Agriculture
- (A-R) Agriculture Residential
- (C-G) General Commercial
- (C-S) Service Commercial
- (O-N) Natural Resource Preservation
- (O-P) Parks & Recreation
- (RS-20) Single Family Residential



Source: Waushara County Zoning 2018
 Prepared by: Waushara County Land Records
 Disclaimer: This data is for Waushara County use and any other use of it the sole responsibility of the user. Waushara County disclaims all liability for any other use of this data.